

Lancashire PVC-u TRADE FRAMES

SOLID SENSE RANGE



# Perfect Sense

The Aluminium Collection



WINDOWS | SLIDING DOORS | BIFOLDING DOORS





## Why it makes Perfect Sense to choose Lancs Trade for Aluminium

We're a business built on a common-sense approach of high standards, great value and responsive service. When we add our expertise to outstanding aluminium systems, you really begin to see the benefits.

### Investment

We have recently made a substantial investment in new equipment for the aluminium fabrication side of our business. The purchases, costing around £150k, were made as a result of our commitment to continually reviewing, updating and upgrading plant and machinery. The new machinery will deliver improved efficiency and allow the business to ensure precision manufacturing on every single order. The new machinery includes: a Blitz Alva 550 double-headed saw with tungsten carbide blades and a motorised mobile saw head with electro-pneumatic control, a Dali 70 CNC controlled machining centre and a Mistral 26 end miller.

### No half measures. Full-on commitment

We're known for fabricating PVC-U, but the market's ready for something different. We've invested in state-of-the-art aluminium machining centres and saws. We've recruited aluminium specialists. We've sourced from the best and we've led the way with our superb aluminium bifolds. We've impressed the trade with our faultless sliding doors. Now, with aluminium windows, the range is complete.

### Everything you want from one supplier

- Fantastic, fully accredited, recyclable, British-made systems
- Superb aesthetics and superb performance
- Choice of styles, configurations and immaculate finishes
- Excellent value and great service.

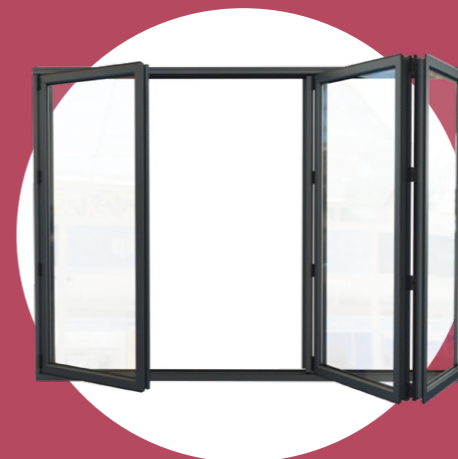

### Visofold 1000

Kitemarked and security-tested to the PAS24 standard, Visofold 1000 slide-folding doors features a choice of internally or externally folding panels, which when open help to integrate your home's external and internal living spaces, offering uninterrupted views.



## Customise your Flowfold solution

**What are my colour options?** Our unrivalled colour range provides the perfect finish for every property. From contemporary urban apartments to traditional Cotswold cottages in conservation areas, we have the ideal colour to suit any project in any location. Our spectrum spans from striking shades of bronze and silver through brilliant reds and gentle blues to traditional white – with virtually every colour and finish in between.

**What about hardware?** Your choice of hardware is an important one as it will have a significant effect on the overall look of your new door. We supply a wide range of high quality options, from the contemporary stainless steel of our new Quantum range to more retro designs, all of which can be supplied in either matching or contrasting colours to your door frame; depending on the look you want to create.

**And glass?** A wide range of glass options is available as part of your window and door system. With double and single glazing, self-cleaning, gas-filled, anti-glare, coated, decorative and energy-efficient units just some of the options! Again, your installer will be able to help you with any questions and to select the most suitable product for your home.

### Why choose aluminium?

Renowned for its perfect combination of light weight and high strength, aluminium is the ideal material for sliding and folding doors, providing slim, elegant designs and outstanding performance.

With a life-span measured in decades rather than years, together with extremely low maintenance requirements, aluminium has become the perfect choice for home owners.

All our systems are designed with performance, looks and efficiency in mind, with each frame incorporating a 'thermal-break' to insulate doors against heat loss, raise the internal temperature of a house and help reduce the risk of condensation.

Maintenance for aluminium systems is simple and straightforward, with a routine 'wipe-clean' all that is required to keep the products looking their best. With no requirement for re-painting or re-varnishing, aluminium windows and doors will never fade, deteriorate or rust, even in harsh environments, or coastal locations.

### How do I assess performance?

There are a number of things to take into account, but also some useful guides to help you:

**Security** – most window and doors will be certified to PAS24. This means the manufacture has been monitored by an accredited certification body. It's worth noting though that this is a minimum standard - it doesn't include higher or lower grades for security.

**Thermal Performance** – this depends on a number of factors, including your system and glazing choice, the direction the door faces and the prevailing weather conditions. When comparing systems, U-values will give you a good guide. These are a standard measure of how good a material is as an insulator – the lower its U-value, the better insulator it is.

**Weather** – as part of the building 'envelope', windows and doors contribute to its overall weather performance, including its water and wind resistance and air-tightness. Manufacturers test their window and door systems to make sure they meet the required performance standards.

Our systems have been designed to not only withstand all that the elements can throw at them, but also to deliver minimum heat loss and great thermal efficiency.

With a dedicated paint line, our colour-matched accessories service means your choice of handles and hinges can be finished in any colour to match or contrast with your door.





**Aluminium has a touch of class.**  
 For some properties, for some architectural styles and for some homeowners, it's the perfect solution.

**Welcome to perfection**

Aluminium is a fabulous material for glazing. It's strong, light, durable and recyclable. It can be formed into almost any shape and can be insulated with thermal break materials. It can be finished in any colour and made into doors and windows where the frames are slim, but the performance is simply superb.

The Perfect Sense collection takes this versatile material to new heights. With a choice of traditional or contemporary styling, it's used for everything from classic casement windows to the streamlined elegance of a sliding door. In a bifolding door, its inherent strength gives aluminium a real advantage over alternative materials.

**Welcome to Perfect Sense**

We're a business built on a common-sense approach of high standards, great value and responsive service. When we add our expertise to outstanding aluminium systems, you really begin to see the benefits. Everything comes together: choice, quality, long-lasting products with superb aesthetics, security and thermal insulation.

We're proud of our commitment to industry and manufacturing excellence. We're also proud to offer this outstanding range of aluminium glazing solutions, because – ticking every box – Perfect Sense makes perfect sense.





## Windows

Our aluminium windows benefit from slim frames. With a great glass to frame ratio, there's more light, views are enhanced and homes feel more open and spacious. It's a bit of magic.

We use top-quality, British designed and manufactured sections. They're equally at home in domestic or commercial installations, with options to suit any property or architectural style.

Immaculately finished, they keep their good looks and protect homes year after year.



### Side hung or top hung?

The choice is yours. We can fabricate casement windows, with outwards opening panes, in almost any layout, to meet your needs.

### Performance

Our windows use sections with a polyamide thermal break. It's smart technology that keeps the cold outside. Combined with double or triple-glazed sealed units, homes can stay warm throughout the worst weather.

Perfect Sense aluminium windows can reach a Band B Window Energy Rating and deliver U-values of 1.3W/m<sup>2</sup>K.

### High standards

The system is designed for lasting performance, thermal insulation, weatherproofing and security. It complies with all relevant standards, UK Building Regulations and PAS 24, and has been Kitemarked by the British Standards Institute.

### Specifications

<b>Maximum dimensions:</b>	<b>Side hung:</b> 1000mm(W) x 1400mm(H)
	<b>Top hung:</b> 1400mm(W) x 1500mm(H)
<b>Glazing:</b>	Double or triple glazed.
<b>Beads:</b>	Ovolo, chamfered or square.
<b>Colours:</b>	Powder-coated finishes in black, white, grey. Dual-coloured options.



## Sliding doors

Think streamlined, clean styling and wide expanses of glass. The appearance is simply stunning, but beyond the wonderful aesthetics, there's advanced engineering that ensures Perfect Sense sliding doors glide effortlessly along their tracks.

With a range of possible configurations, including triple-track thresholds which allow a full 2/3 of the aperture to be opened, every property can enjoy easier access to outdoors. The layout saves space, with panes stacking neatly, but when closed, multipoint locking keeps homes weatherproof and secure.

Craftsman built with real attention to detail, these sliding doors are fully bespoke for a perfect fit and easy installation.



### Fully accredited

Even the smallest sliding doors need to be structurally sound, and ours meet all the requirements of Document L. Doors are Kitemarked by the British Standards Institute to BS 6375-1:2009.

### Choose your layout

Designed to fit anywhere, a Perfect Sense sliding door can be fabricated with 2, 3 or 4 panes. You can choose which panes move – and even with a 2-pane style, both panes can slide. Triple-track options give you a much wider opening and are ideal for opening a home to the great outdoors.

The sections are so slim, you can even use the system for horizontal sliding windows. The appearance is always uncluttered and the proportions work beautifully.

### Protection

Sliding doors have to protect and insulate, and that's precisely what the system is designed to do. The aluminium is thermally broken for insulation, and superb seals and gaskets prevent draughts and leaks. Tested and proven to withstand the British weather, they'll keep homes warm and dry.

Perfect Sense sliding doors can deliver U-values of 1.6W/m<sup>2</sup>K.

### Specifications

Max. height:	2100mm
Max. door weight:	200kg
Glazing:	Double or triple glazed.
Beads:	Ovolo, chamfered or square.
Colours:	Powder-coated finishes in black, white, grey. Dual-coloured options.





## Bifolding doors

With beautiful, floor-to-ceiling glass, rooms are transformed, gardens made more accessible, and entertaining is more fun. FlowFold is a superbly engineered, aluminium bi-folding door, designed specifically for domestic use. It's ideal for a pool-house, a garden office, in a conservatory or to replace a French door. It even excels as an internal room divider.

Smooth and easy to operate, the panes can be folded internally or externally. For unimpeded access low-thresholds are available, and we also offer a rebated threshold for those more exposed areas where extra weather protection may be required.



FlowFold doors are weather resistant to BS 6375 Part 1 and fully compliant with Document L of the Building Regulations. The system is PAS 24 accredited.



### Performance

The doors are fully bespoke, configured exactly how you want them, with your choice of access door position. The simplest doors have just two folding leaves, but you can have as many as seven, allowing you to have a great expanse of glass and a wide-open home.

Leaves can stack indoors or out, to the left or the right, and the traffic door can be in any position. If you need a very low threshold for wheelchair access, that's no problem.

### Safe and sound

FlowFold uses slim but robust aluminium sections which incorporate polyamide thermal breaks to keep homes insulated. Long-lasting EPDM gaskets and brush seals keep the British weather at bay all year round.

For peace of mind, we use top-quality multipoint locking system and simple to operate shootbolts to secure each folding leaf.

FlowFold bifolding doors can reach U-values of 1.5W/m<sup>2</sup>K.

### Specifications

Max. height:	2500mm
Max. leaf width:	1200mm
Max. door weight:	100kg
Glazing:	Double or triple glazed.
Colours:	Powder-coated finishes in black, white, grey. Dual-coloured options.



### Durable and practical

Aluminium is really practical. Lightweight but very strong, it's easy to handle but tough enough to cope in a busy family home.

Every part of the Perfect Sense range is designed for a long, trouble-free life. Sections are finished using a marine-quality, polyester powder coat, so they won't corrode or oxidise, and our doors and windows need very little maintenance – just an occasional wash and brush up!

### Every detail matters

We take great care with the details – from the precision of the mitred joints to the placement of every screw and the quality of each component. That's why we're sure you'll get lasting satisfaction from our aluminium windows and doors.

### Reassuringly secure

From toughened glass to robust locking mechanisms, we've thought of everything when it comes to security. Our aluminium range features highly-secure, multi-point locks and all panes are internally glazed. With Flowfold, the leaves are fitted, top and bottom, with shoot-bolt mechanisms. Our sliding doors include anti-jacking systems, advanced locking and highly secure keeps.

### Reliable

We're committed to providing the best quality, high-performing, stylish, energy-efficient and secure windows and doors to our customers. We're committed to ensuring a smooth, hassle-free and straightforward installation from our friendly team and we're committed, 100%, to your satisfaction.

We know a lot about aluminium windows and doors and we'll be ready with advice when you need it. Our people are highly experienced and FENSA registered. Every component used in our aluminium range is of market-leading quality and carries our ten-year insurance-backed guarantee.

### Responsible

Our aluminium sections are produced and powder coated in the UK. We use a supplier with fantastic green credentials and a comprehensive environmental management system. Waste is kept to a minimum, recycling is a key policy and energy consumption is strictly controlled.

Once your windows or doors are fabricated and installed, they will go on looking after the environment by insulating your home and reducing your carbon emissions. You'll never need to paint them, and because they won't rot, you don't need to use any nasty chemicals to preserve them.

We expect that your Perfect Sense windows and doors will be with you for decades, but don't forget that the aluminium sections can be recycled when the time, eventually, comes to say goodbye!

### Insulation

Perfect Sense windows and doors protect your home from the weather without relying on ugly, black, rubber seals. High-quality, long-life EPDM gaskets keep the rain on the outside and weather-brushes prevent draughts.

The aluminium sections are multi-chambered and include a polyamide thermal break which reduces heat loss. As standard, we use 28mm, sealed-unit, double glazing made with advanced, low-emissivity glass that can help to improve your home's passive solar gain.

All our windows and doors are weather resistant to BS 6375 Part 1 and fully compliant with Document L of the building regulations.



## Every detail matters

We take great care with the details – from the precision of the mitred joints to the placement of every screw and the quality of each component. That's why we're sure you'll get lasting satisfaction from our aluminium windows and doors.





## Design

Slide-folding doors feature multiple door leaves which concertina to one or both sides of the frame.

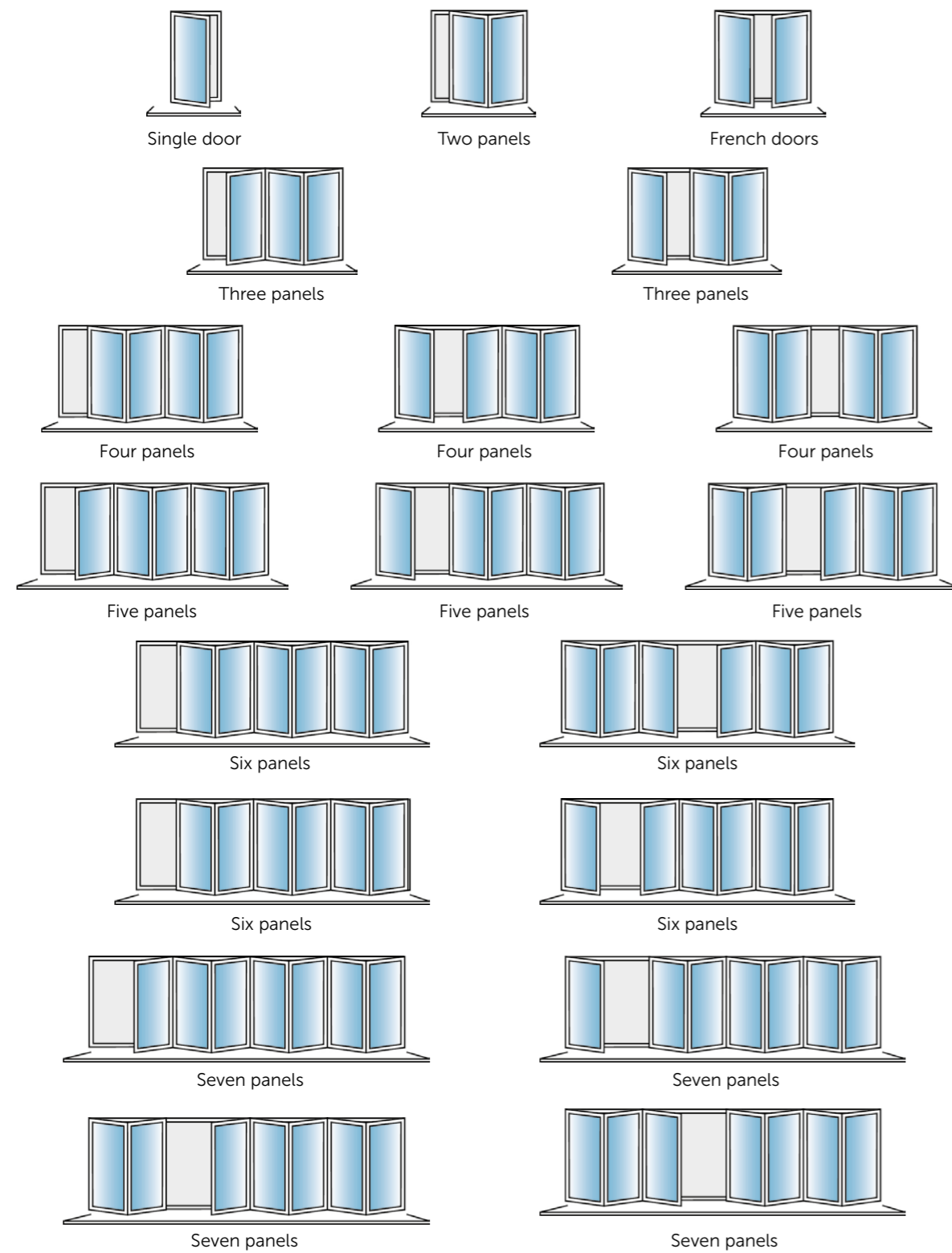

**SS Flowfold: Aluminium Bi-Folds™**

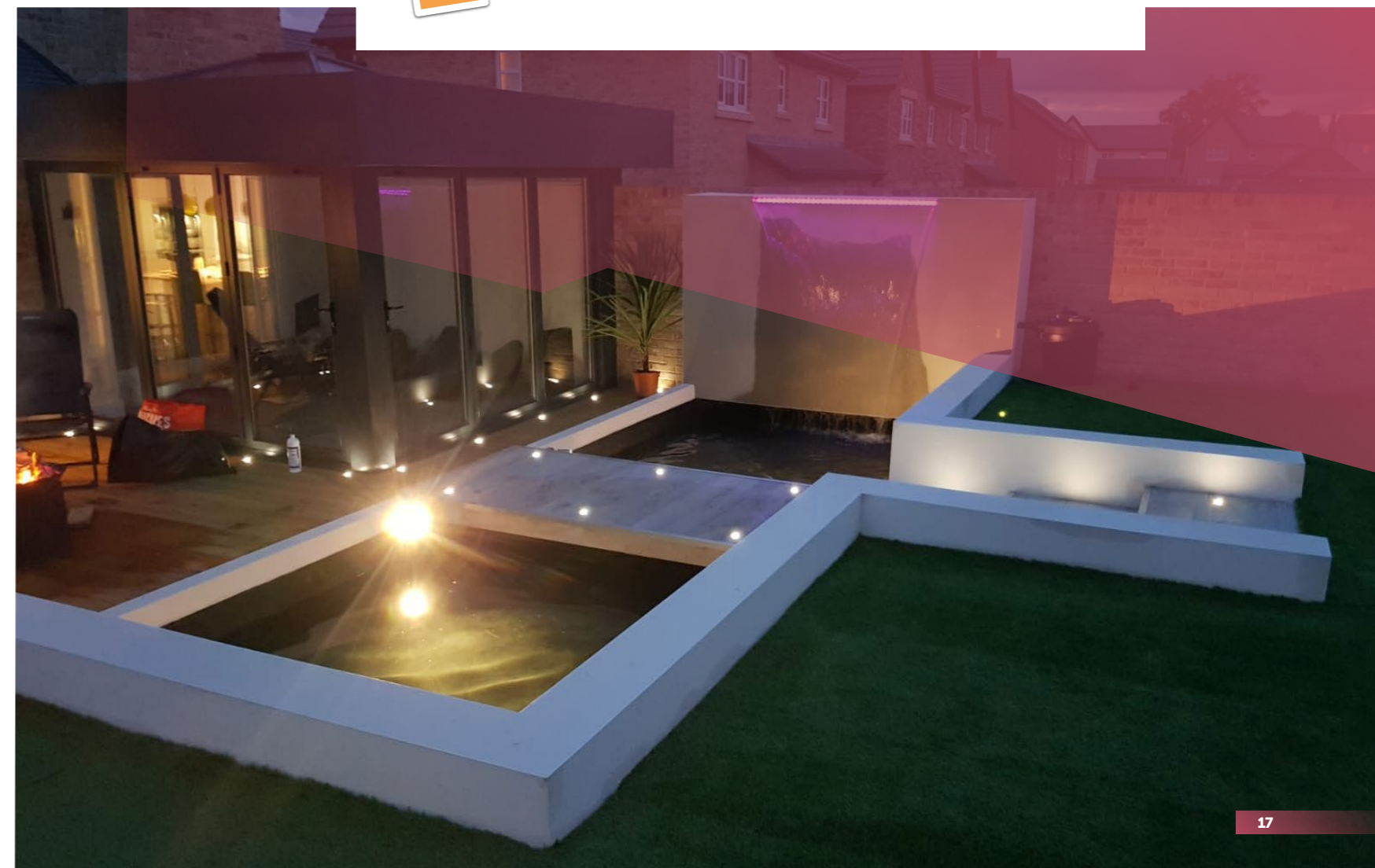



## Perfect Sense The Aluminium Collection



**Lancashire** PVC-u  
TRADE FRAMES

**Perfect Sense** The Aluminium Collection

**T** 0161 762 5800  
**E** [sales@lancstrade.co.uk](mailto:sales@lancstrade.co.uk)  
**W** [www.lancstrade.co.uk](http://www.lancstrade.co.uk)